

Welcome to Delphi!

2023-2024 School Year



Welcome!

We are so excited to welcome you and your family to Delphi!

This school year we are excited to join together with you as an amazing team to ensure your family is reaching all your educational goals! Your child's(ren's) progress, safety and happiness is our goal!



In this pack you will find:

- 23/24 School Event Calendar...(pg 3)
- Campus Map.. (pg 4)
- Schedule & Daily Drop Off/Pick UP...(pg 5)
- How Parents Can Access the Delphi Campus...(pg 6)
- What to Bring to School...(pg 6 & 7)
- Food Service...(pg 7 & 8)
- Attendance & Lateness...(pg 8-11)
- Our Amazing Staff & Contact List...(pg 12 & 13)
- School Announcements - Stay Updated!...(pg 13 & 14)
- Teamwork!...(pg 14)
- Dress Code...(pg 15 & 16)
- Student use of Electronics at School...(pg 19)
- Emergency Protocols... (pg 22)
- Ethics... (pg 23)
- Delphi Parent Organization...(pg 24)
- Illness Guidelines - when to isolate?...(pg 25)

2023-2024 Delphi Florida School Schedule and Events Calendar

Key:

	Delphi Parent Organization (DPO) Event
	Summer Camp

	School Closed
	School Event

August 2023						
Su	M	Tu	W	Th	F	Sa
30	31	1	2	3	4	5
6	7	8	9	10	11	12
13	14	15	16	17	18	19
20	21	22	23	24	25	26
27	28	29	30	31		

August	
31-4	Summer Break (School Closed)
4	Preschool Orientation
7	First Day of School for the 23/24 School Year
11	High School Orientation
18	Lower School Orientation
18	Elementary & Middle School Orientation
25	DPO Launch and Meet & Greet

September 2023						
Su	M	Tu	W	Th	F	Sa
					1	2
3	4	5	6	7	8	9
10	11	12	13	14	15	16
17	18	19	20	21	22	23
24	25	26	27	28	29	30

September	
4	Labor Day (School Closed)
27	Picture Day

October 2023						
Su	M	Tu	W	Th	F	Sa
1	2	3	4	5	6	7
8	9	10	11	12	13	14
15	16	17	18	19	20	21
22	23	24	25	26	27	28
29	30	31				

October	
9	Staff Professional Development (School Closed)
11	Geography & History Fair
16	DPO Poinsettia Fundraiser Kick-Off
23-27	Delphi Spirit Week
27	DPO Trunk or Treat

November 2023						
Su	M	Tu	W	Th	F	Sa
		1	2	3	4	
5	6	7	8	9	10	11
12	13	14	15	16	17	18
19	20	21	22	23	24	25
26	27	28	29	30		

November	
8	Picture Relate Day
6-16	School-wide Food Drive
16	DPO Poinsettia Delivery
20-24	Thanksgiving Break (School Closed)

December 2023						
Su	M	Tu	W	Th	F	Sa
					1	2
3	4	5	6	7	8	9
10	11	12	13	14	15	16
17	18	19	20	21	22	23
24	25	26	27	28	29	30
31						

December	
1-13	DPO Giving Tree
8	Preschool Holiday Show
14	Lower School Holiday Show
15	Elementary, Middle & High School Holiday Show
18-1	Winter Break (School Closed)

January 2024						
Su	M	Tu	W	Th	F	Sa
	1	2	3	4	5	6
7	8	9	10	11	12	13
14	15	16	17	18	19	20
21	22	23	24	25	26	27
28	29	30	31			

January	
1	Last Day of Winter Break (School Closed)
12	Spelling Bee
15	Martin Luther King Day (School Closed)
18	Middle & High School Science Fair
22-26	Kindness Week

February 2024						
Su	M	Tu	W	Th	F	Sa
				1	2	3
4	5	6	7	8	9	10
11	12	13	14	15	16	17
18	19	20	21	22	23	24
25	26	27	28	29		

February	
2	Re-Enrollment Deadline
3	DPO Delphi Carnival
14	DPO Valentine's Day Staff Appreciation Brunch
19	President's Day (School Closed)

March 2024						
Su	M	Tu	W	Th	F	Sa
					1	2
3	4	5	6	7	8	9
10	11	12	13	14	15	16
17	18	19	20	21	22	23
24	25	26	27	28	29	30
31						

March	
2	Fun Run
11-15	Spring Break (School Closed)
28-30	Spring Show

April 2024						
Su	M	Tu	W	Th	F	Sa
	1	2	3	4	5	6
7	8	9	10	11	12	13
14	15	16	17	18	19	20
21	22	23	24	25	26	27
28	29	30				

April	
26	Music Cafe

May 2024						
Su	M	Tu	W	Th	F	Sa
		1	2	3	4	
5	6	7	8	9	10	11
12	13	14	15	16	17	18
19	20	21	22	23	24	25
26	27	28	29	30	31	

May	
6-10	DPO Staff Appreciation Week
9	Preschool Mothers Day
10	DPO Mother's Day Tea
19	DPO Pool Party
27	Memorial Day (School Closed)
29	Preschool & Lower School Awards Ceremonies
30	Last Day of School

May/June 2024						
Su	M	Tu	W	Th	F	Sa
	27	28	29	30	31	1
2	3	4	5	6	7	8
9	10	11	12	13	14	15
16	17	18	19	20	21	22
23	24	25	26	27	28	29
30						

May/June	
30	Elem & Mid School Awards Ceremony
30	High School Awards Ceremony & Commencement
3-7	Summer Break (School Closed)
10-28	Summer Camp

July 2024						
Su	M	Tu	W	Th	F	Sa
	1	2	3	4	5	6
7	8	9	10	11	12	13
14	15	16	17	18	19	20
21	22	23	24	25	26	27
28	29	30	31			

July	
1-19	Summer Camp
4	4th of July (School Closed)

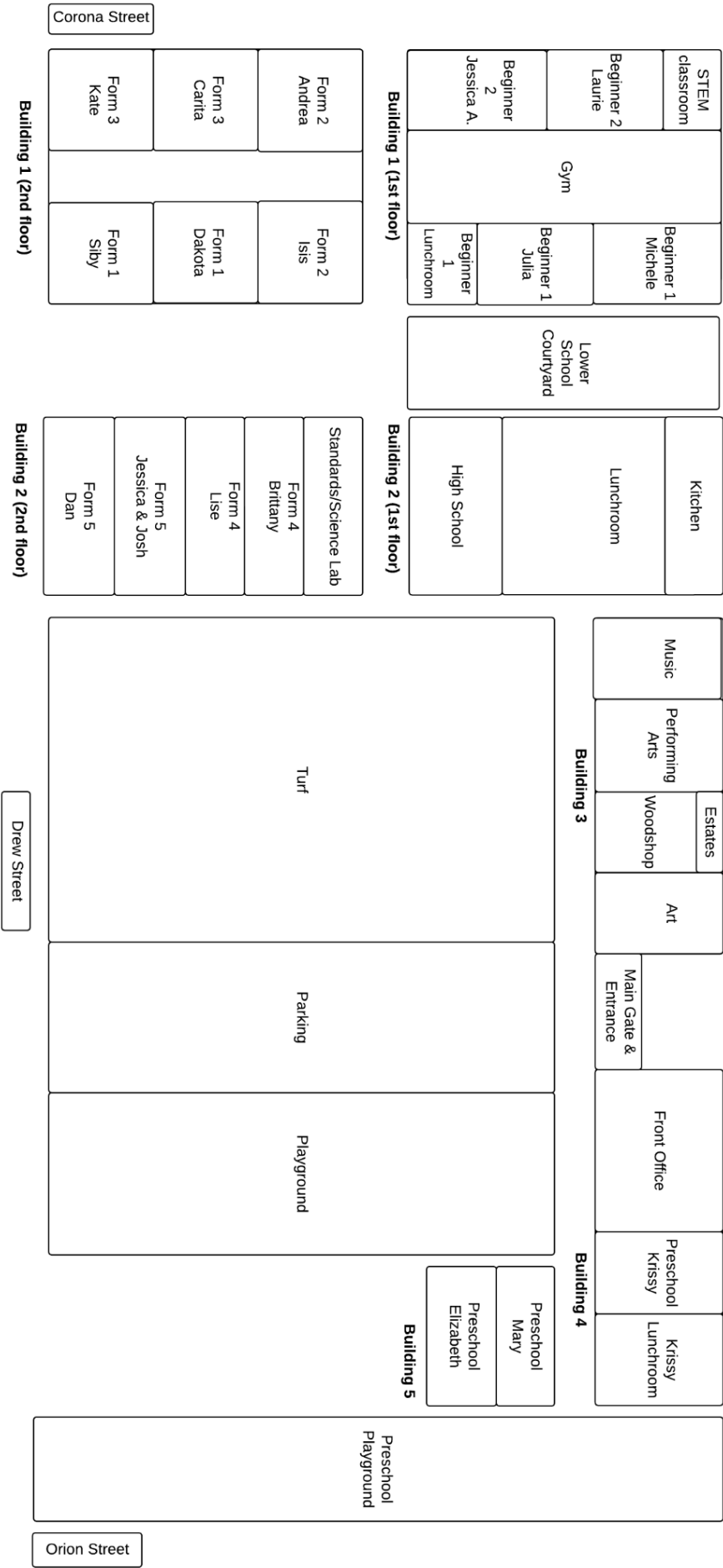

Schedule & Daily Drop Off/Pick UP

We begin each day, in every class with a morning orientation to the day. This is where we talk about how the day will go, get ready to learn and even set personal goals for the day! This is the **MOST** important time for every child, Preschool thru High School - so don't be late!

Drive up Drop off and Pick up

- **Drop off: 8:30 a.m. - 8:59 a.m.**
- **Late Drop-off** - Students being dropped off after 9:00 a.m. must come to the office with a parent to sign in. If the student is in Beginner 1, Beginner 2 or Form 1, the parent will need to wait with him/her until a designated staff member takes them to class. This could take up to 15 minutes. All other students may go straight to their classroom.
- **Arrive to class by 9:00 for your roll call!**
- **Pick up time** is from **4:45 p.m. - 5:15 p.m.**
- **Early Pick-up** must be arranged through your child's teacher 24 hours in advance. All students must be picked up and signed out in the main office.
- **Late Pick-up** Students who are not picked up by 5:15 p.m. will need to be picked up from the office, and a late pick up fee of \$10 will be billed for up to 15 minutes late and \$10 for every 15 minutes after that.

Drive Up Drop Off/Pick Up Map

Ages 4 to 17 (Beginner 1 - High School) will be dropped off at the drop off location in **RED**. Preschool drop off for ages 2 & 3 will be in front of the school office in **YELLOW**. Please see the map below:



How Parents Can Access the Delphi Campus during school hours

The Delphi campus can be accessed through the School Main Office. Please sign in and obtain your visitor badge before leaving the office.

What to Bring to School

Lunch/Snacks: You will need to provide daily lunch and two snacks for your child. Some classrooms and the lunchroom have microwaves available for heating up food. Send cutlery if needed, along with any needed condiments, such as ketchup, for their meals and a filled water bottle. We are excited to promote a healthy lifestyle here at Delphi and encourage you to send lots of fresh fruits, veggies, nuts, cheeses and other proteins.



We do ask that you send foods with a very low or no sugar content. It can be hard at times to figure out new foods but our teachers have great suggestions! Please reach out to them at any time for new ideas.

Personal Items: Please limit personal items to lunchboxes, water bottles, outerwear and a backpack (if desired). If your child's teacher sends homework or books to read, this can come back the following day. Please leave toys at home!

Food Service Program & NEW (2023/24) Outside Food Delivery rules *(no Uber Eats, Doordash or other delivery services allowed)*

Outside food delivery is allowed by our APPROVED restaurants only. This change is due to security issues with so many random drivers from food delivery services like Uber Eats accessing our campus. The following approved restaurants are known and are currently working with us, so food can be sent from them only. Unknown drivers will not be permitted access to our campus. If lunch is forgotten at home, you can drop it off at the main office. All food must be dropped off prior to the lunch period so that it can be eaten prior to afternoon classes.

APPROVED LUNCH DELIVERY RESTAURANTS

Joe's Deli & Grill

joesdeliandgrill@gmail.com (order online and can set delivery time!)
727-466-0502

Manos Bakery

727-614-9748 (must call to order - use THEIR driver)

FOOD SERVICES PROGRAM: Available for Form 1 through High School

THIS is a GREAT option if you are not able to pack a lunch for your child. Our student-run Food Services Program will start a few weeks

after school has started, and the updated menu will be shared at that time. Here are the instructions for ordering:

How to Order from Delphi Food Services

1. On the menu, find the LETTER(S) and NUMBER next to the food item (ex. M1 (Monday, choice #1), Th4 (Thursday, choice #4))
2. Through CashApp, send \$DelphiStudentCouncil the amount needed and write in the "for" section the Letter-Number combination, the student's name, and the form he or she is in. (ex. M1 Billy Bob Form 4)

Leaving Campus for Lunch

High School students on Junior and Senior programs may leave campus for lunch if they have a permission slip from their parents. Students wishing to drive other High School students, or be passengers of other students, must complete the Student Driver waiver and permission paperwork in the office.

Attendance & Lateness

Our school day begins at **9:00 a.m.**

High School students (Junior and Seniors only) may leave campus for lunch but they must have parental permission and must sign out & in through the main office. Any student involved in a disciplinary situation will have this privilege revoked.

Arriving at school daily, and on time, is crucial to the success of your child's education. As Delphi Academy is a licensed Florida State School we are subject to satisfying the attendance requirements of Florida law.

Tardiness is defined as any student that has missed a roll call. Morning roll call is at 9:00 a.m. In Form 3 and above, students will also be marked tardy if they arrive at any instructional or practical slot late. For every 3 days of tardiness, the student will obtain 1 unexcused absence, however there are instances where a tardy is excused.

Absences are any student missing from one half of the school instructional day. Additionally, specific to Middle and High School, those who miss one full study period per day will be marked absent.

Excused tardiness/absence are as follows:

- The student is ill, suspected of having an infestation or communicable disease or has suffered an injury
- The student has a major illness or medical situation in their immediate family
- The student has a scheduled medical or dental appointment (arranged with the teacher)
- A death in the family
- College visitation approved and coordinated with the teacher
- Religious holiday in the student's own faith

Unexcused tardiness/absence are as follows:

- Oversleeping or "needing more sleep"
- Car or transportation problem including traffic
- Stopping for gas or picking up items
- Returning home for forgotten items
- Parent work conference or work call
- Dropping off other household members (siblings etc.)
- Attendance at a special event or volunteerism not approved at least one week ahead of time by the School Director and Assistant Head of School
- Any non-holiday related religious event not approved at least one week ahead of time by the School Director and Assistant Head of

School. Not to exceed 2 days. This time off can only be approved for students on target within the full Delphi program

- Vacations or days off for pleasure or family events
- Birthdays

Students are responsible for coordinating with their teacher(s) to make up any work missed due to tardiness/absences. This may include attending study hall, missing a field trip or doing extra homework. After 5 days of absence due to illness during a single report card period a doctor's note should be provided.

Parents are expected to let the school know by 9:30 a.m. if their child will be absent and the reason for the absence. If an absence is not reported, it will automatically be considered unexcused.

Habitual Absences or Tardies:

Excessive absences or tardiness for any reason will delay the progress of your child within the Delphi program. Any student who falls behind 30 days or more on their program will not be eligible for automatic re-enrollment into the next school year without a provisional enrollment agreement that includes a solution and handling of all academic arrears and a prevention plan of attendance/tardiness issues.

After 3 unexcused tardies or unexcused absences, parents will be requested to come in for a meeting with their child's teacher and the school director to determine a solution. If lateness persists after this meeting and/or a total of 6 unexcused tardies have accrued, a meeting with the School Director or Dean will be requested. This applies to all students in Beginner 1 on up through High School.

After 15 unexcused tardies within 90 days a student will be suspended and not permitted to return until the parent and school are aligned on attendance. If unexcused tardies continue, the parent may be asked to seek another academic environment.

Truancy: Florida law defines truant as a student who has 15 or more unexcused absences within a 90 calendar day period. This applies to all children who are of an age where school is required by state law starting in Kindergarten through High School.

Students 14-18 years of age who have 15 unexcused absences within 90 calendar days and have a Florida driver's license will have their driver's license suspended by the Division of Highway Safety and Motor Vehicles or will not be issued a license if they apply for one. (Section 322.091, F.S.)

Our Amazing Staff & Contact List

We have very well qualified teachers that will be working with your family while your child is enrolled. They are available to speak with you if you have any questions. You can contact them at any time but remember that they are with the students and may not be able to answer you immediately. Teachers do not take or answer calls, texts or email while teaching or supervising their class. Communications will be answered within 24 hours.

If you need immediate assistance you can always contact the school office at (727) 447-6385, extension 200.



Teacher and Administrative Staff Email List

First Name	Last Name	Department
Alex	Campana	High School Teacher
Ana	Fey	Director of Standards
Belinda	Young	Business Manager
Brittany	Bartilson	Form 4 Teacher
Carita	Lewis	Form 3 Teacher
Ceadar	Van Den Berg	3's Preschool Teacher Assistant
Carol	Kirtley	Elementary School Director
Dakota	Young	Form 1 Teacher
Dan	Coates	Form 5 Teacher
Deb	Voss	Assistant Head of School
Ellen	Garrison	Head of School
Gena	Runyon	Dean for Beginner 1 - Form 5
Elizabeth	Patella	Preschool Director
Genevieve	Botehlo	Director of Human Resources
George	Pilat	Science/Lab Teacher
Greg	Scott	Woodshop Teacher
Isis	Starks	Form 2 Teacher
Ivonne	Pontius	Spanish Teacher
Jeanie	Arnold	High School Teacher
Jessica	Bara-Skowronek	Form 5 Teacher
Jessica	Argjendari	Beginner 2 Teacher
Josh	Doheny	Form 5 Teacher
Joan	Crane	Art Teacher
Judy	Reid	Administrative Assistant
Julia	Taylor	Beginner 1 Teacher
Kate	Lannoye	Form 3 Teacher
Kelly	Ehst	Director of Admissions
Krissy	Leonard	2's Preschool Teacher
Laurie	Bush	Beginner 2 Teacher
Lise	McCrerey	Form 4 Teacher
Luca	Marazzo	High School Teacher
Mary	Imburgia	3's Preschool Teacher
Michele	Cormier	Beginner 1 Teacher
Nicole	Haskin	High School Teacher

First Name	Last Name	Department
Sarah	Stryker	Establishment Director
Siby	Beitel	Form 1 Teacher
Timea	Victorino	2's Teacher Assistant
Tracey	Campana	Director of Student Enrichment
Vickie	Spencer	Finance Director

School Announcements - Stay Updated & Involved!

Delphi Academy of Florida uses "all school" emails and Facebook to keep our parents up to date on announcements, updates, and school happenings!

Parent/Teacher Communication will come to you either via email or text, depending on the teacher who will be in touch with you at the start of the year.

Follow our school Facebook page **Delphi Academy of Florida** (facebook.com/DelphiFL) for school announcements and updates!

Private Groups:

Delphi Parent Organization (DPO) (facebook.com/groups/delphifl) -

This is a group for our Parent Organization, keep up to date on DPO events, parent volunteer opportunities and coordination!

Delphi Florida Lower School (facebook.com/groups/delphilowerschool) -

This is a group for parents of students in Beginner 1, Beginner 2, Form 1 and Form 2!

Delphi Florida Preschool (facebook.com/groups/delhipreschool) - This is a group for parents of students in Preschool!

Delphi Florida Elementary School (Form 3 & 4)

(facebook.com/groups/2162425267312994) - This is a group for parents of students in Form 3 & 4!

Delphi Florida Upper School ([Facebook.com/groups/delphiupperschool](https://www.facebook.com/groups/delphiupperschool))

- Join this group if you have children in Form 5 or High School!

Delphi Academy of Florida Alumni

([facebook.com/groups/181493219140829](https://www.facebook.com/groups/181493219140829)) -

Delphi Graduates are encouraged to join our Delphi Alumni page. Visit our Facebook group and our Delphi Alumni Committee to see how they support the school and overall mission of Delphi!

Ideal Delphi of Florida ([facebook.com/groups/539000201275042](https://www.facebook.com/groups/539000201275042))

All parents and friends of Delphi Florida are invited to join the Ideal Delphi of Florida facebook page to see the latest news on our Ideal Campus Project led by our Development Committee.

Teamwork

A very important aspect of being a part of the Delphi Community is teamwork and communication between the parent, school and child to best help a child succeed. On occasion your family may experience what could be referred to as "weathering a storm", where a child may run into something challenging at school or in life. This is what we like to call "a learning opportunity". This is when the parent, teacher, student team must be stronger than ever and is needed the most.

Our dedicated team is here to help you and your children through any rough "weather" and get everyone back to sunny skies. If such should occur, contact your child's teacher first as she/he has the best understanding of what might be occurring. If you need additional help, your School Director can also assist. The fastest approach to any concern or challenge is directly with the school. We are here to help your children in every way.

Student Dress Code

At Delphi we believe that your dress is a communication. It is often one of the first communications we extend from ourselves, as individuals to others and is often a manners point. For example, it would not be "in" manners if you wore a swimsuit to a formal wedding. At our school we strive to have our student body reflect the high standards of Delphi itself. This is in no way an attempt to limit a student's ability to express themselves but to have a median in a sea of viewpoints on appropriate dress. As our main focus at Delphi is to educate, we have put together the following dress code that we feel is a happy median to all those enrolled from Beginner 1 through High School. The school's Dress Code Committee meets regularly to review current trends and issue guidelines to help clarify current standards, which are as follows:

HAIR

- Hair should be kept neat, clean and well trimmed.
- If hair is longer it must be worn in a bun or style that does not cover the eyes.
- Hair color should be natural. Temp hair color can be used on occasion.

HEADWEAR

- Hats, caps, beanies and bandanas should not be worn inside the building.

CLOTHING

- Clothing should be appropriate for school and its activities. (Costumes, sleepwear, see through, sheer, mesh etc. should not be worn.)
- Clothing should be neat, clean and in good repair.
- No clothing is to be adorned with logos or words that promote messages inappropriate for school or children.
- PE clothing should be appropriate and not revealing, too tight, too short or in any way distract from the class.
- All clothing should fit and not result in undergarments being outlined or seen.

Tops:

- Tops should be such that it does not show bare midriffs, underwear or chest/cleavage. This includes PE wear.
- Tops should not be strapless or have draping arm holes that expose undergarments. Tank tops should be at least 1 $\frac{1}{2}$ inches thick.
- Tops should not cover the bottom hem of your shorts so as to look like you are just wearing a shirt.

Shorts/Skirts:

- Skirts should not be shorter than 3 inches above the knee and not be shorter than where your hand falls naturally at your side. Shorts should be close to at least a 3.5 inch inseam and should NEVER expose private body parts or be suggestive in nature. Tops should not cover the bottom hem of the shorts. Shorter skirts and dresses may be worn with tights that are not see through or with leggings. No spandex shorts with the exception of sports may be worn and then only be worn during that sport or practice and should be long enough as to not resemble underwear.

Pants:

- Sweatpants are not allowed but athleisure joggers are permitted see Photo A for the difference.
- No PJ or sleepwear bottoms
- Distressed jeans are fine but without obvious holes, see Photo B for example.
- Leggings may be worn only with a shirt that otherwise covers the crotch of the leggings. See photo C for example.

SPECIALTY CLOTHING

If a student has an activity to attend that requires specialty clothing which falls outside of the Dress Code parameters (such as sportswear, dance clothing, costumes, etc.), the student would attend school in their Dress Code attire and change into their specialty clothing for the duration of the activity.

SHOES

Shoes must be worn at all times on campus. Shoes should be appropriate for school and all its activities. Any type of footwear that

limits a student's ability to easily climb stairs or run should not be worn. Dress shoes and modest heels are appropriate for Professional Dress Day.

ACCESSORIES AND GROOMING

- Earrings may be worn that do not inhibit movement or pose potential for harm during school activities.
- Face piercings, ear lobe gauges, tongue, or lip piercings are not allowed.
- No visible tattoos are allowed.

All students are expected to come to school clean, and free of body odor. Middle School and High School girls are allowed to wear light, day make-up. Out of courtesy to others, strong fragrances should not be worn.

LOWER SCHOOL

For safety reasons, Lower School students are required to wear a Delphi t-shirt while on school outings and field trips. These shirts are available for purchase in the school bookstore.

Additional Dress Code Requirements for Middle/High School

- Facial hair must be well groomed and cared for.

PROFESSIONAL DRESS DAY

To help prepare our students for the career world, every Friday is Professional Dress Day for students in Form 5 and up. The older the student, the more closely we expect the following guidelines to be followed. We have a cool weather period and a warm weather period.

COOL WEATHER

The cool weather period runs from the first Friday after Thanksgiving until the Friday prior to Spring Break.

Boys:

- Dress slacks with the pants belted.
- Dress style shirt and tie.
- A sport coat or suit is optional but certainly in line with dressing professionally.
- Dress shoes (not athletic shoes) be worn with appropriate dress socks (not gym or ankle socks).

Girls:

- Professional dresses that meet length requirements as above. Body con dresses are not professional dress.
- Dress slacks or skirts.
- Dress shirt.
- Shoes should be of modest heel (1-2" for Middle School students and up to 3.5" for High School students) and be sturdy enough to be walked in easily.

WARM WEATHER

The warm weather period runs from the first Friday after Spring Break until the Friday prior to Thanksgiving.

Boys: A boy's outfit would be both smart and neat with a polo shirt or short sleeve button down shirt without a tie and tailored shorts (not denim or beach/water style) with clean low court type dress sneakers (see Photo D), boat shoes, loafers or dress shoes.

Girls: For girls, the look would be similarly smart and neat with a dress, skirt, tailored shorts or skirt and a blouse, sleeveless shirt or dressy pullover with clean footwear that complement the outfit.

DRESS CODE VIOLATIONS

Should a student be found to be in violation of the dress code, the student's teacher can contact the parents to either bring the student appropriate dress for school or bring the student home to change. The student will be shown the dress code, and a copy should be sent to the parents for review as well.

Photo A:



Photo B:



Photo C:



Photo D:



Student use of Electronics at School

At Delphi we understand the benefits of utilizing electronics to enhance learning experiences in ever expanding ways, as well as to maintain efficient coordination with family and peers. We also understand the possible abuses that can occur which can overall detract and distract from a productive school environment.

It has been found that students have sometimes gotten distracted from their studies, or are missing valuable communication and interaction with their peers and faculty. Therefore the following are the electronic policies listed by area.

High School (Freshman - Senior)

High school (Freshman - Senior) students are required to bring personal laptops to school as they are used consistently throughout their class time for essays, to do research, to keep track of their programs, to download course materials, etc.

High School (Freshman - Senior) students may use cell phones for school or Student Council related activities. They may also use them during designated break times, such as snack and lunch time. At all other times, they are turned off and kept in a common location as directed by the teacher. Please note this policy can change at any time. **Parents** - please do not text or call your children during study time, text the teacher or contact the main office if there's an urgency.

Phones and devices must be turned off while waiting to be picked up so as to set a good example for younger students who are not allowed to use phones during pick up time.

High School students are held to a high ethical standard in terms of their use of electronics at school. Any violation of that trust would be handled appropriately with the student's teacher or School Director. Continued or repeated or severe violations will result in a student not being able to bring their electronics to school.

Middle School (Form 5)

Personal computers are not allowed in Middle School. School computers may be used by Middle School students in the classroom for essays and

research. School computers may not be used for personal reasons, or for things not school related.

Cell phones, personal laptops & tablets, smart watches and other personal telecommunication devices are not to be used on campus during the school day. This includes during class time, practical classes, before school, breaks, lunch and while waiting to be picked up. The only exception is to make a quick call to coordinate pick up with parents. Once done, the device must be put away, out of sight.

Personal telecommunication devices are not to be used during off-campus school activities.

If a student brings a personal telecommunication device on campus it is to be turned off and kept out of sight and silent until the student leaves campus. It is stored in a backpack, locker, or in the teacher's care - depending on the individual teacher's discretion of where these are stored.

Elementary School (Forms 3 & 4)

Form 3: Personal electronic devices (laptops, cellphones, etc.) are not permitted to be brought to school. Students are permitted to use school computers.

Parents can communicate with their child's teacher or the office if there is a message that needs to be relayed.

Form 4: Personal computers and tablets are not permitted in Form 4. Students are permitted to use school computers.

Cell phone rules for Form 4 are the same as Form 5. Cell phones are not to be used on campus during the school day. This includes during class time, practical classes, before school, breaks, lunch and while waiting to be picked up.

Lower School (Beginner 1 - Form 2)

Personal electronic devices (laptops, cellphones, etc.) are not permitted and should not be brought to school. Parents can communicate with their child's teacher or the office if there is a message that needs to be relayed.

Consequences

The first time a student violates our electronics policy, they will be asked to shut it off and put it away. The second time the teacher takes the device, and holds it or brings it to the office where it is kept for the rest of the school day. The student can pick it up after 4:45. The third time the student is not allowed to bring a phone or electronic device to school for 5 school days. The fourth time the student will not be allowed to bring a phone or electronic device to school for the rest of the school year.

Ethics

One of the many unique aspects of student life at Delphi is the dedication to our school's logo points. Knowledge, Ethics, Integrity and Leadership are key to the Delphi culture. We know that there are always moments in a person's life when these character traits can be strongly challenged or even compromised, and the school is committed to help students sort out any difficulties. Please refer to the Delphi Parent-Student Handbook for detailed information regarding student Ethics.

Emergency Protocols

The school has specific protocols for any situation including dangerous criminal activity in the area, fire, intruder and severe weather which

could include a Tropical Storm, Hurricane, Tornado or other deemed as such by the National Weather Service.

Weather Watches/Warnings

The School Safety Committee monitors all severe weather with our National Weather Service Radio located in the office. Should a severe weather warning or watch be issued during the school day typically due to a sudden onset of potentially destructive winds, rain, lightning or in case of a tornado, the school will follow our severe weather lockdown procedures until the weather has passed. Should this happen during pick up times, please look out for notifications from the school for any changes to our pick up procedures for that day.

Hurricanes/Tropical Storms

There is more weather prediction with larger storms such as hurricanes and tropical storms, and so for the safety of our students and staff, the school may close during these larger storms. We follow the lead of the Pinellas County School District when it comes to closing the school for an impending storm, as they receive direct updates and guidance from the Pinellas County Emergency Management. Their updates on school closures can be found on their home page at WWW.PCSB.ORG. Additional emails will be sent out if the school will be closed, and with our reopening schedule.

In the rare instance where the school needs to close due to impending severe weather during the school day, you will receive notification from the school with instructions, and a specified time of when your child must be picked up from school due to the closure. It is important that students are picked up at the specified time for everyone's safety.

Delphi Parent Organization: A Message from our President

The Delphi Parent Organization (DPO) is the Delphi Academy of Florida's Parent Group. It is widely known from coast to coast that we are one of the best parent groups around!

The DPO Mission is: "To enhance campus life by creating activities that engage and empower staff, students and families. Some of these activities include fundraisers, game nights, potlucks and fun events which serve to deepen our school spirit and enrich our children's educational and social experiences."

We are looking forward to the new school year and with that being said, we will be distributing a dedicated DPO events 2023-2024 calendar very soon. All parents will be given the opportunity to participate in our calendar events/activities and become a part of our amazing Delphi community! Our success is directly related to the amount of parental participation that we have. 😊

The DPO meets once a month on a Friday (exact date and time is announced monthly). Join us, be informed, volunteer, and more! Email us at DPO@delphifl.org to get involved or email Rosie directly at rosieishere@icloud.com. Be sure to also join our Facebook group: <https://www.facebook.com/groups/delphifl/>. Regular DPO updates are posted here and it's a great way to stay connected.

DPO President:
[Rosie Lucia Purden](#)

DPO Vice President
[Kasia Miley](#)

Illness Guidelines

We all hate it when a child is not feeling well! We have health guidelines that we follow to keep everyone healthy!

If your child has any of the following symptoms please keep them home from school for the day and return them to school based on the criteria below:

- ★ Fever - If your child has a temperature over 99.5, we consider that a fever. Your child will need to be **fever free for 24 hours** without the use of medication before returning to school.
- ★ Eye drainage or red, itchy eye - The child should be checked by a doctor. And if not contagious may return to school with a Doctor's note.
- ★ Coughing - If there is **persistent or excessive** coughing, whether dry or wet, the child should be out of school until symptoms are gone. This could be a sign of **whooping cough or strep throat**. The child should be checked by a doctor.
- ★ Sore throat - please keep your child home until symptom free.
- ★ Rash - Any **rash that could possibly be transmittable, hand-foot-and-mouth disease, measles or chickenpox**—the child should be checked by a doctor.
- ★ Any skin infection - The child should be out of school until on antibiotics or other treatment for the amount of time the doctor states that it is no longer contagious to others (this includes fungus infections like ringworm, impetigo, etc.).
- ★ Runny Nose - All runny noses whether clear or not, must stay home unless allergy related. If it is allergy related, a note from your child's doctor is required for us to have on file.

- ★ Vomiting or Diarrhea - Must stay home & be symptom free for 24 hours.
- ★ If your child is ill and will not be at school for the day, please contact us at 727-447-6385 as soon as possible so we can inform your child's teacher.

When a child isn't feeling well at school we will check for the following symptoms:

- Fever (any temperature above 99.5)
- Continuous runny nose
- Congestion
- Wet or dry Persistent or excessive cough
- Frequent sneezing
- Sore throat
- Vomiting or diarrhea

If a student has any of the symptoms above, they will be sent home. You may receive a call from either the Director, Teacher or School Health Coordinator to pick up your child. We do ask that students being sent home for illness be picked up within 30 minutes from the front office.

If we suspect heat related symptoms/dehydration we will have the student drink some fluids and relax for a little while to see if the symptoms subside. If not, the student will be sent home.

- Headache
- Fatigue
- Nausea
- Body or muscle aches
- Lethargic

Protocol if your child has allergies:

Your child may enter the school with a medical doctor's note stating that they are not contagious and that their symptoms are from allergies. The note must be within the last 3 months, and state which symptoms they have at that time (so we can differentiate if new symptoms are occurring). If they have a fever, a doctor's note will not be accepted. They will need to remain home and be symptom free for 24 hours, without medication before returning.

Hygiene

- Children will be regularly taught the importance of washing hands and the proper way to do it. There are "proper handwashing" signs in every bathroom
- Handwashing will be done throughout the day. Hand sanitizer is provided in each classroom

Cleaning, Sanitizing, Disinfecting

- Commercial cleaning company crew disinfects all classrooms and bathrooms nightly
- Teachers sanitize commonly touched surfaces throughout the day
- As much as possible, students will have their own materials and not share with others

Who to contact for school health questions?

Belinda Young: belinday@delphifl.org

We look forward to an amazing 2023/2024 School Year!